

Standard Room Set-up:

Community Room: 2 tables set in a square seating for 10 & podium, 32 chairs in theater style, Pull down screen, public address system.
2 extra tables in the back of the room

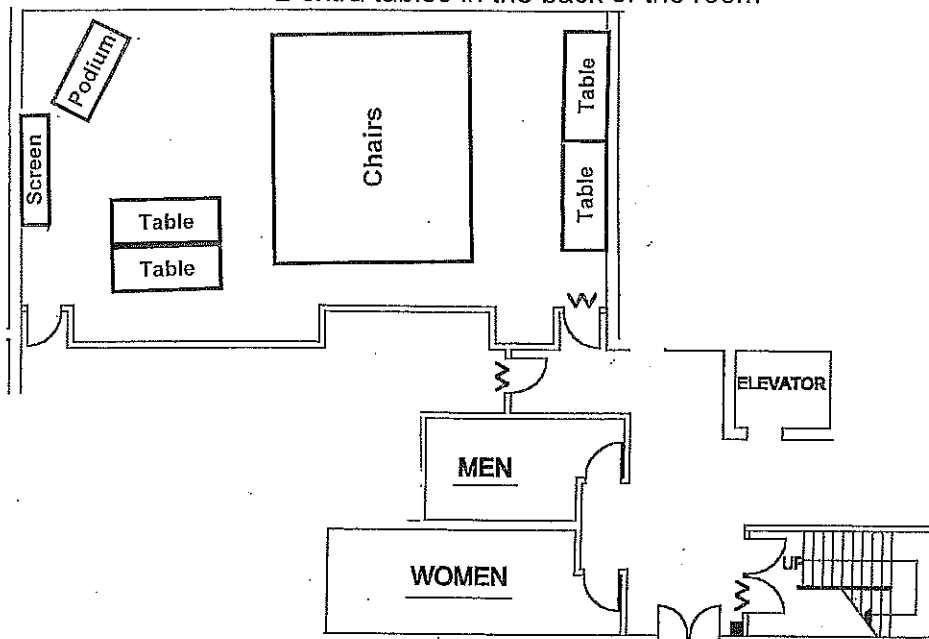

Foot Room (right side): Head table & podium, 50 chairs in theater style, pull-down screen, a public address system. Additional chairs are available

(left side): 4 tables in square, seats 16

(in alcove): former City Council table, seats 14

